

## VILLAGE OF REDGRANITE ZONING UPDATE 2013

-  AG HOLDING
-  RESIDENTIAL
-  MOBILE HOME PARK
-  COMMUNITY COMMERCIAL
-  HIGHWAY COMMERCIAL
-  INDUSTRIAL
-  TOWN OF WARREN
-  ROADS
-  WATER

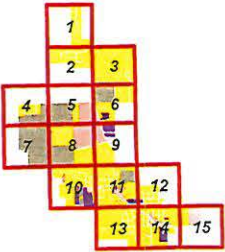

Source: Village of Redgranite Zoning, 2003  
Digital Base Data provided by Waushara County.

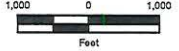

This data was created for use by the East Central Wisconsin Regional Planning Commission Geographic Information System. Any other use/application of this information is the responsibility of the user and such use/application is at their own risk. East Central Wisconsin Regional Planning Commission disclaims all liability regarding fitness of the information for any use other than for East Central Wisconsin Regional Planning Commission business.

Prepared By  
EAST CENTRAL WISCONSIN  
REGIONAL PLANNING COMMISSION-MAY 2013

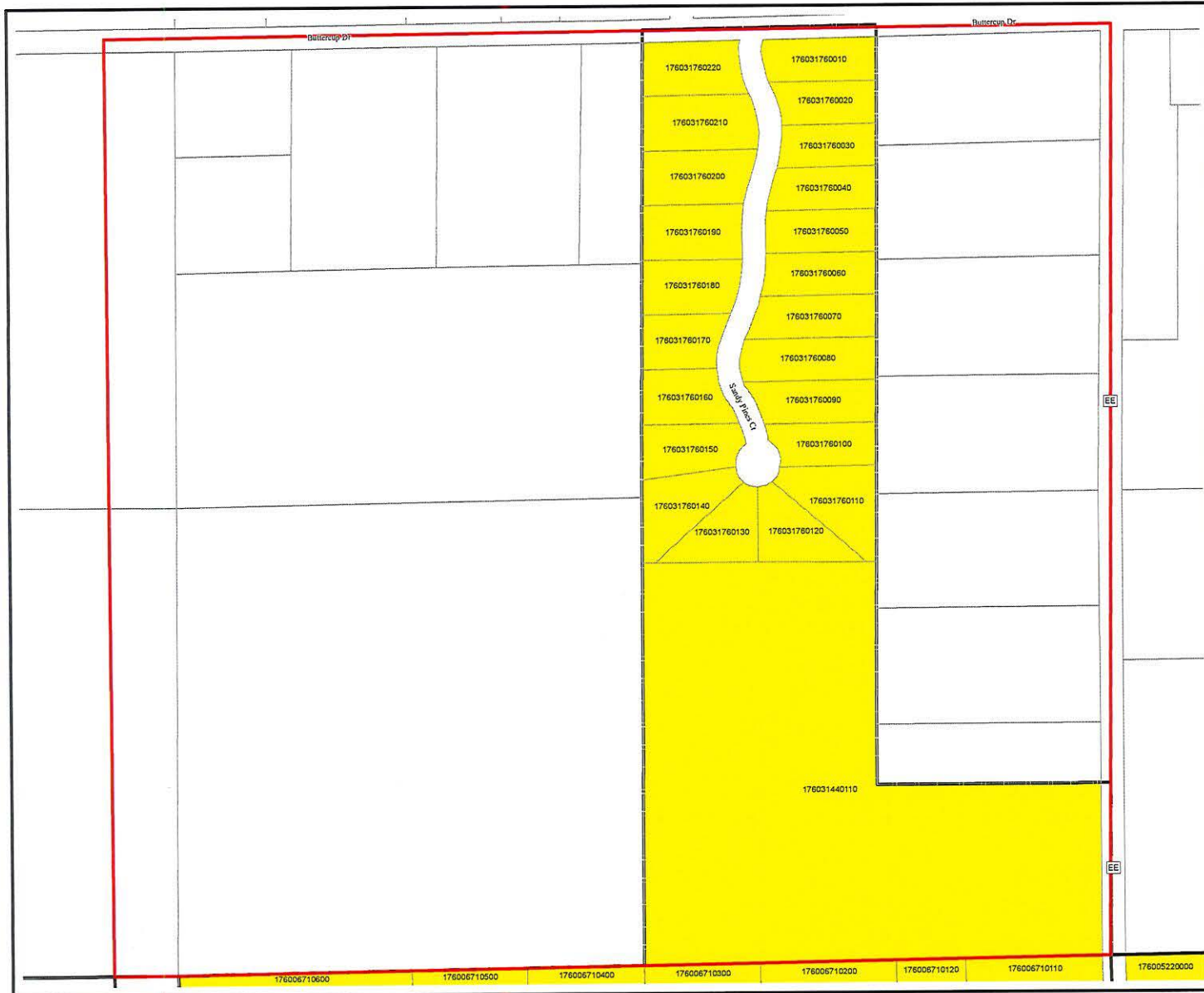

# VILLAGE OF REDGRANITE ZONING PAGE 1

- AG HOLDING
- RESIDENTIAL
- MOBILE HOME PARK
- COMMUNITY COMMERCIAL
- HIGHWAY COMMERCIAL
- INDUSTRIAL
- TOWN OF WARREN
- ROADS
- WATER

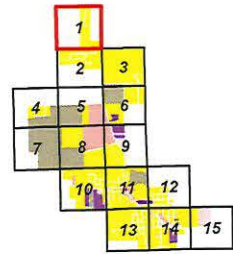

Source: Village of Redgranite Zoning, 2003  
Digital Base Data provided by Waushara County.

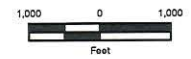

This data was created for use by the East Central Wisconsin Regional Planning Commission Geographic Information System. Any other use/application of this information is the responsibility of the user and such use/application is at their own risk. East Central Wisconsin Regional Planning Commission disclaims all liability regarding fitness of the information for any use other than for East Central Wisconsin Regional Planning Commission business.

Prepared By  
EAST CENTRAL WISCONSIN  
REGIONAL PLANNING COMMISSION-MAY 2013







## VILLAGE OF REDGRANITE ZONING PAGE 3

-  AG HOLDING
-  RESIDENTIAL
-  MOBILE HOME PARK
-  COMMUNITY COMMERCIAL
-  HIGHWAY COMMERCIAL
-  INDUSTRIAL
-  TOWN OF WARREN
-  ROADS
-  WATER

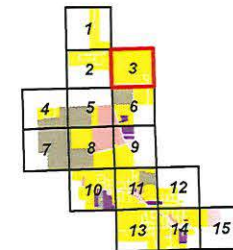

Source: Village of Redgranite Zoning, 2003  
Digital Base Data provided by Waushara County.

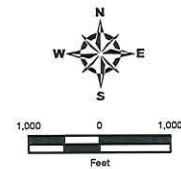

This data was created for use by the East Central Wisconsin Regional Planning Commission Geographic Information System. Any other use/application of this information is the responsibility of the user and such use/application is at their own risk. East Central Wisconsin Regional Planning Commission disclaims all liability regarding fitness of the information for any use other than for East Central Wisconsin Regional Planning Commission business.

Prepared By  
EAST CENTRAL WISCONSIN  
REGIONAL PLANNING COMMISSION-MAY 2013

# VILLAGE OF REDGRANITE ZONING PAGE 4

-  AG HOLDING
-  RESIDENTIAL
-  MOBILE HOME PARK
-  COMMUNITY COMMERCIAL
-  HIGHWAY COMMERCIAL
-  INDUSTRIAL
-  TOWN OF WARREN
-  ROADS
-  WATER

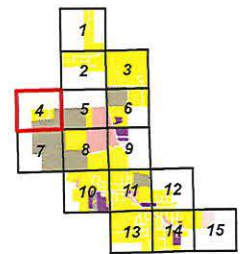

Source: Village of Redgranite Zoning, 2003  
Digital Base Data provided by Waushara County.

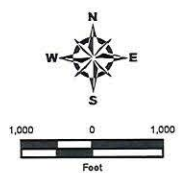

This data was created for use by the East Central Wisconsin Regional Planning Commission Geographic Information System. Any other use/application of this information is the responsibility of the user and such use/application is at their own risk. East Central Wisconsin Regional Planning Commission disclaims all liability regarding fitness of the information for any use other than for East Central Wisconsin Regional Planning Commission business.

Prepared By  
EAST CENTRAL WISCONSIN  
REGIONAL PLANNING COMMISSION-MAY 2013







# VILLAGE OF REDGRANITE ZONING PAGE 5

-  AG HOLDING
-  RESIDENTIAL
-  MOBILE HOME PARK
-  COMMUNITY COMMERCIAL
-  HIGHWAY COMMERCIAL
-  INDUSTRIAL
-  TOWN OF WARREN
-  ROADS
-  WATER

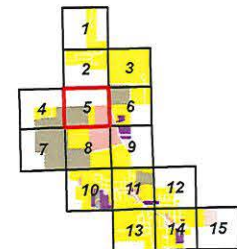

Source: Village of Redgranite Zoning, 2003 Digital Base Data provided by Waushara County.



This data was created for use by the East Central Wisconsin Regional Planning Commission Geographic Information System. Any other use/application of this information is the responsibility of the user and such use/application is at their own risk. East Central Wisconsin Regional Planning Commission disclaims all liability regarding fitness of the information for any use other than for East Central Wisconsin Regional Planning Commission business.

Prepared By  
EAST CENTRAL WISCONSIN  
REGIONAL PLANNING COMMISSION-MAY 2013



# VILLAGE OF REDGRANITE ZONING PAGE 6

-  AG HOLDING
-  RESIDENTIAL
-  MOBILE HOME PARK
-  COMMUNITY COMMERCIAL
-  HIGHWAY COMMERCIAL
-  INDUSTRIAL
-  TOWN OF WARREN
-  ROADS
-  WATER

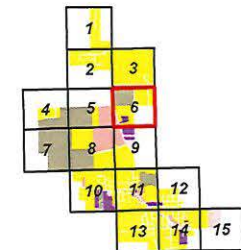

Source: Village of Redgranite Zoning, 2003  
Digital Base Data provided by Waushara County.

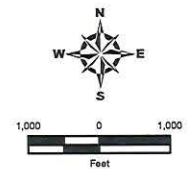

This data was created for use by the East Central Wisconsin Regional Planning Commission Geographic Information System. Any other use/application of this information is the responsibility of the user and such use/application is at their own risk. East Central Wisconsin Regional Planning Commission disclaims all liability regarding fitness of the information for any use other than for East Central Wisconsin Regional Planning Commission business.

Prepared By  
EAST CENTRAL WISCONSIN  
REGIONAL PLANNING COMMISSION-MAY 2013



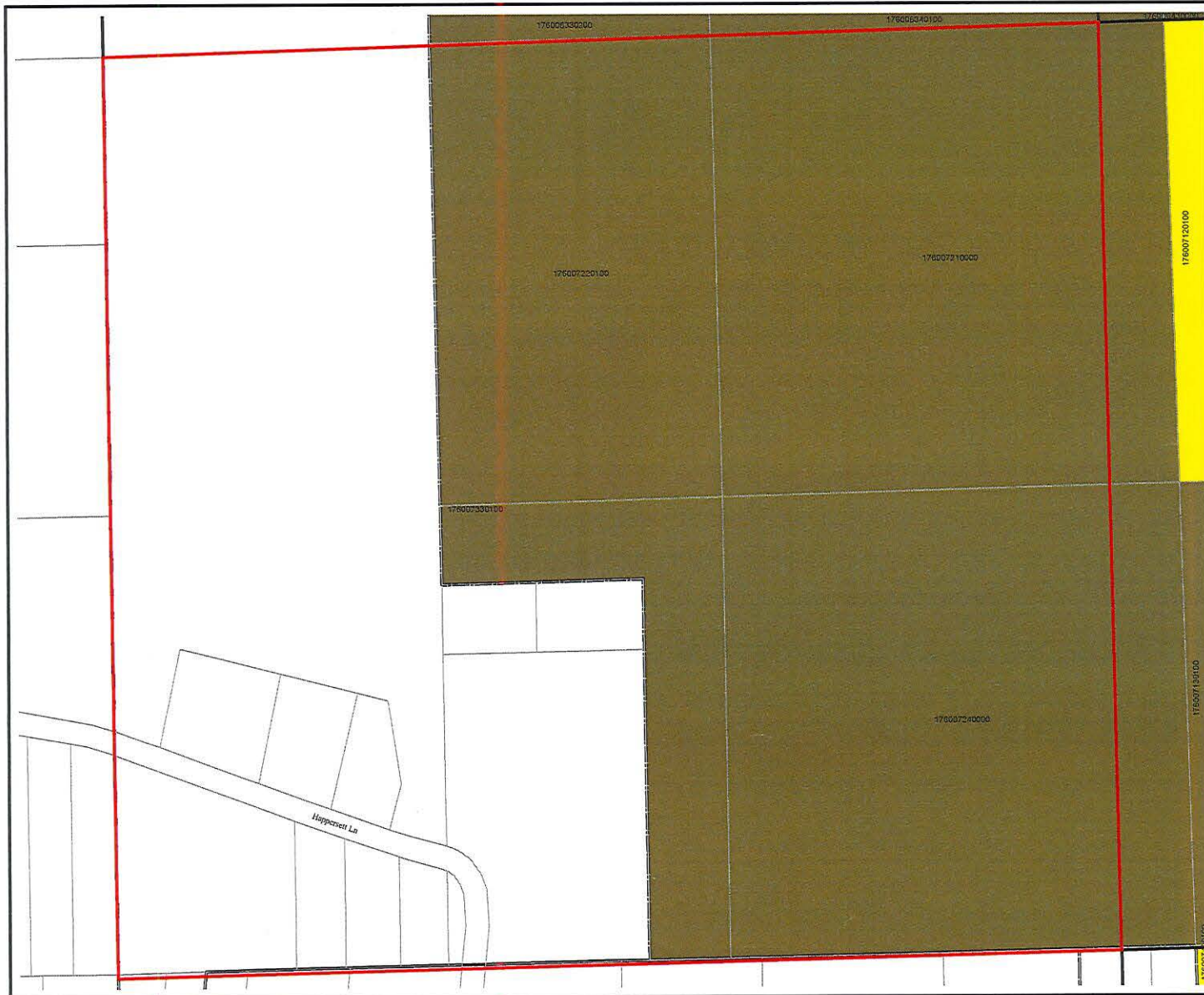

# VILLAGE OF REDGRANITE ZONING PAGE 7

-  AG HOLDING
-  RESIDENTIAL
-  MOBILE HOME PARK
-  COMMUNITY COMMERCIAL
-  HIGHWAY COMMERCIAL
-  INDUSTRIAL
-  TOWN OF WARREN
-  ROADS
-  WATER

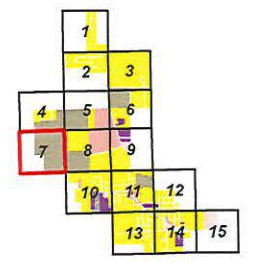

Source: Village of Redgranite Zoning, 2003  
 Digital Base Data provided by Waushara County.

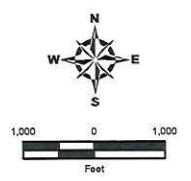

This data was created for use by the East Central Wisconsin Regional Planning Commission Geographic Information System. Any other use/application of this information is the responsibility of the user and such use/application is at their own risk. East Central Wisconsin Regional Planning Commission disclaims all liability regarding fitness of the information for any use other than for East Central Wisconsin Regional Planning Commission business.

Prepared By  
 EAST CENTRAL WISCONSIN  
 REGIONAL PLANNING COMMISSION-MAY 2013





## VILLAGE OF REDGRANITE ZONING PAGE 8

-  AG HOLDING
-  RESIDENTIAL
-  MOBILE HOME PARK
-  COMMUNITY COMMERCIAL
-  HIGHWAY COMMERCIAL
-  INDUSTRIAL
-  TOWN OF WARREN
-  ROADS
-  WATER

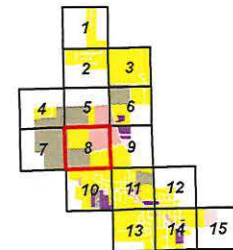

Source: Village of Redgranite Zoning, 2003  
Digital Base Data provided by Waushara County.

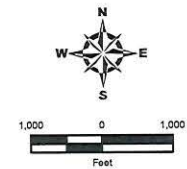

This data was created for use by the East Central Wisconsin Regional Planning Commission Geographic Information System. Any other use/application of this information is the responsibility of the user and such use/application is at their own risk. East Central Wisconsin Regional Planning Commission disclaims all liability regarding fitness of the information for any use other than for East Central Wisconsin Regional Planning Commission business.

Prepared By  
EAST CENTRAL WISCONSIN  
REGIONAL PLANNING COMMISSION-MAY 2013

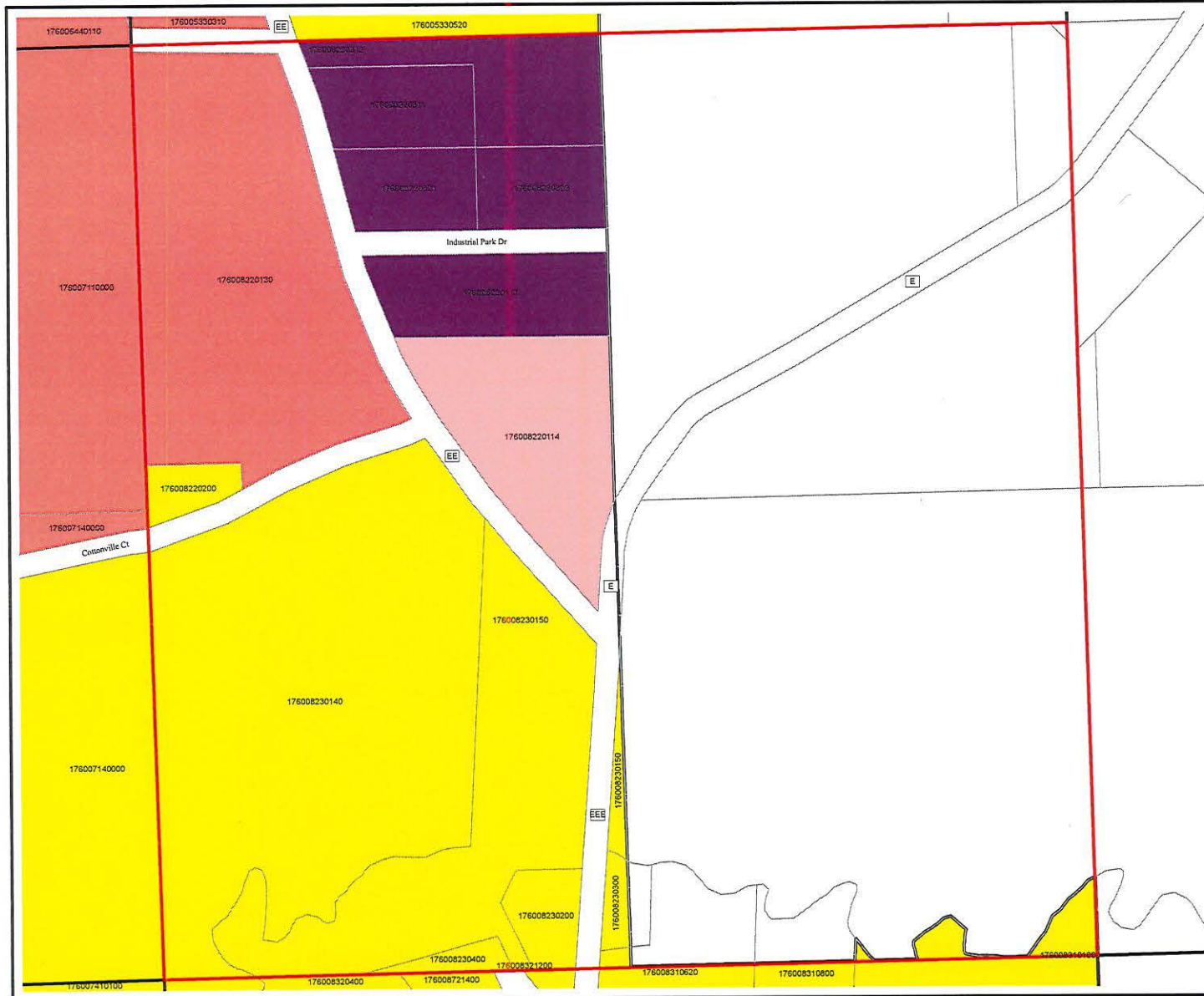

# VILLAGE OF REDGRANITE ZONING PAGE 9

-  AG HOLDING
-  RESIDENTIAL
-  MOBILE HOME PARK
-  COMMUNITY COMMERCIAL
-  HIGHWAY COMMERCIAL
-  INDUSTRIAL
-  TOWN OF WARREN
-  ROADS
-  WATER

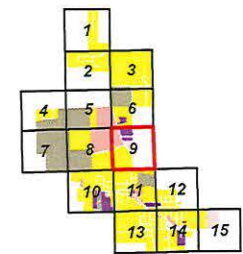

Source: Village of Redgranite Zoning, 2003  
 Digital Base Data provided by Waushara County.

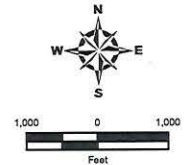

This data was created for use by the East Central Wisconsin Regional Planning Commission Geographic Information System. Any other use/application of this information is the responsibility of the user and such use/application is at their own risk. East Central Wisconsin Regional Planning Commission disclaims all liability regarding fitness of the information for any use other than for East Central Wisconsin Regional Planning Commission business.

Prepared By  
 EAST CENTRAL WISCONSIN  
 REGIONAL PLANNING COMMISSION-MAY 2013





# VILLAGE OF REDGRANITE ZONING PAGE 10

- AG HOLDING
- RESIDENTIAL
- MOBILE HOME PARK
- COMMUNITY COMMERCIAL
- HIGHWAY COMMERCIAL
- INDUSTRIAL
- TOWN OF WARREN
- ROADS
- WATER

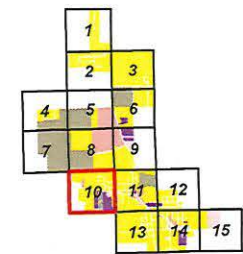

Source: Village of Redgranite Zoning, 2003  
 Digital Base Data provided by Waushara County.

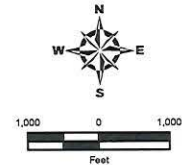

This data was created for use by the East Central Wisconsin Regional Planning Commission Geographic Information System. Any other use/application of this information is the responsibility of the user and such use/application is at their own risk. East Central Wisconsin Regional Planning Commission disclaims all liability regarding fitness of the information for any use other than for East Central Wisconsin Regional Planning Commission business.

Prepared By  
 EAST CENTRAL WISCONSIN  
 REGIONAL PLANNING COMMISSION-MAY 2013



# VILLAGE OF REDGRANITE ZONING PAGE 11

-  AG HOLDING
-  RESIDENTIAL
-  MOBILE HOME PARK
-  COMMUNITY COMMERCIAL
-  HIGHWAY COMMERCIAL
-  INDUSTRIAL
-  TOWN OF WARREN
-  ROADS
-  WATER

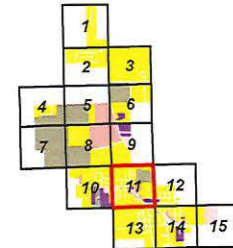

Source: Village of Redgranite Zoning, 2003  
Digital Base Data provided by Waushara County.

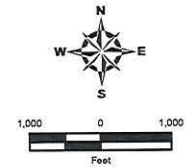

This data was created for use by the East Central Wisconsin Regional Planning Commission Geographic Information System. Any other use/application of this information is the responsibility of the user and such use/application is at their own risk. East Central Wisconsin Regional Planning Commission disclaims all liability regarding fitness of the information for any use other than for East Central Wisconsin Regional Planning Commission business.

Prepared By  
EAST CENTRAL WISCONSIN  
REGIONAL PLANNING COMMISSION-MAY 2013

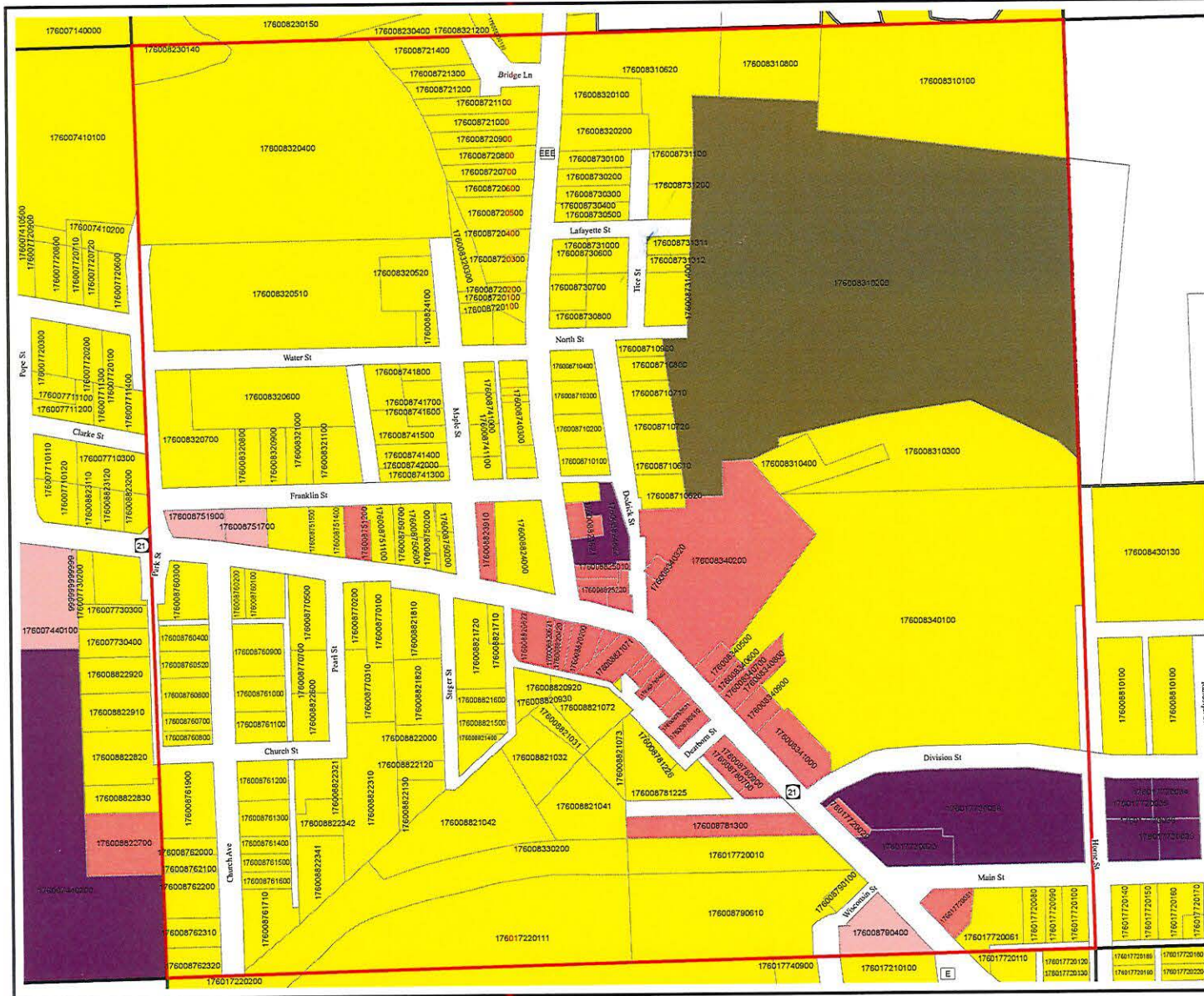





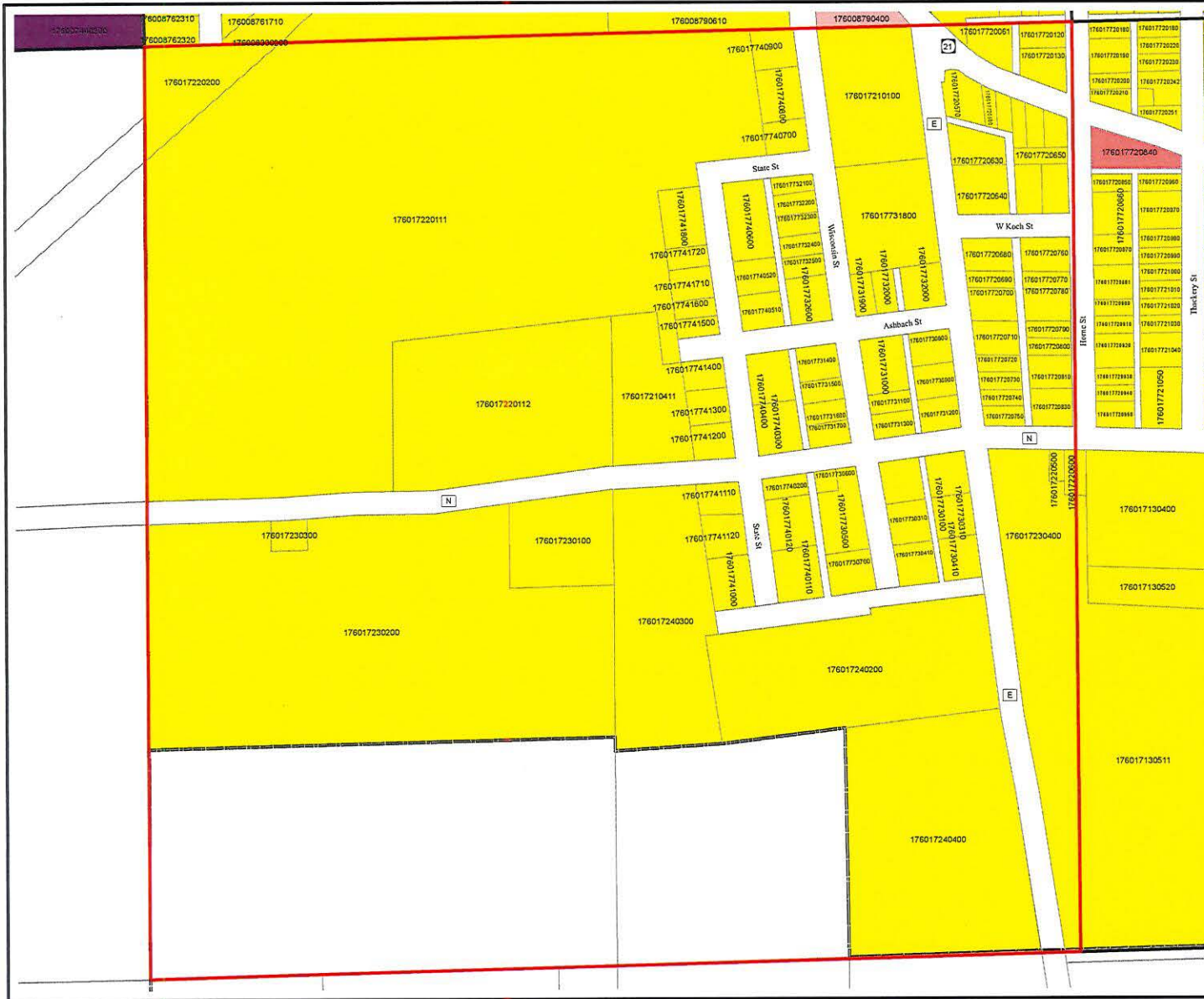

## VILLAGE OF REDGRANITE ZONING PAGE 13

- AG HOLDING
- RESIDENTIAL
- MOBILE HOME PARK
- COMMUNITY COMMERCIAL
- HIGHWAY COMMERCIAL
- INDUSTRIAL
- TOWN OF WARREN
- ROADS
- WATER

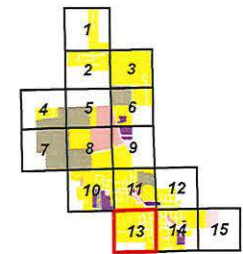

Source: Village of Redgranite Zoning, 2003  
 Digital Base Data provided by Waushara County.

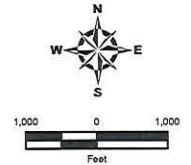

This data was created for use by the East Central Wisconsin Regional Planning Commission Geographic Information System. Any other use/application of this information is the responsibility of the user and such use/application is at their own risk. East Central Wisconsin Regional Planning Commission disclaims all liability regarding fitness of the information for any use other than for East Central Wisconsin Regional Planning Commission business.

Prepared By  
 EAST CENTRAL WISCONSIN  
 REGIONAL PLANNING COMMISSION-MAY 2013





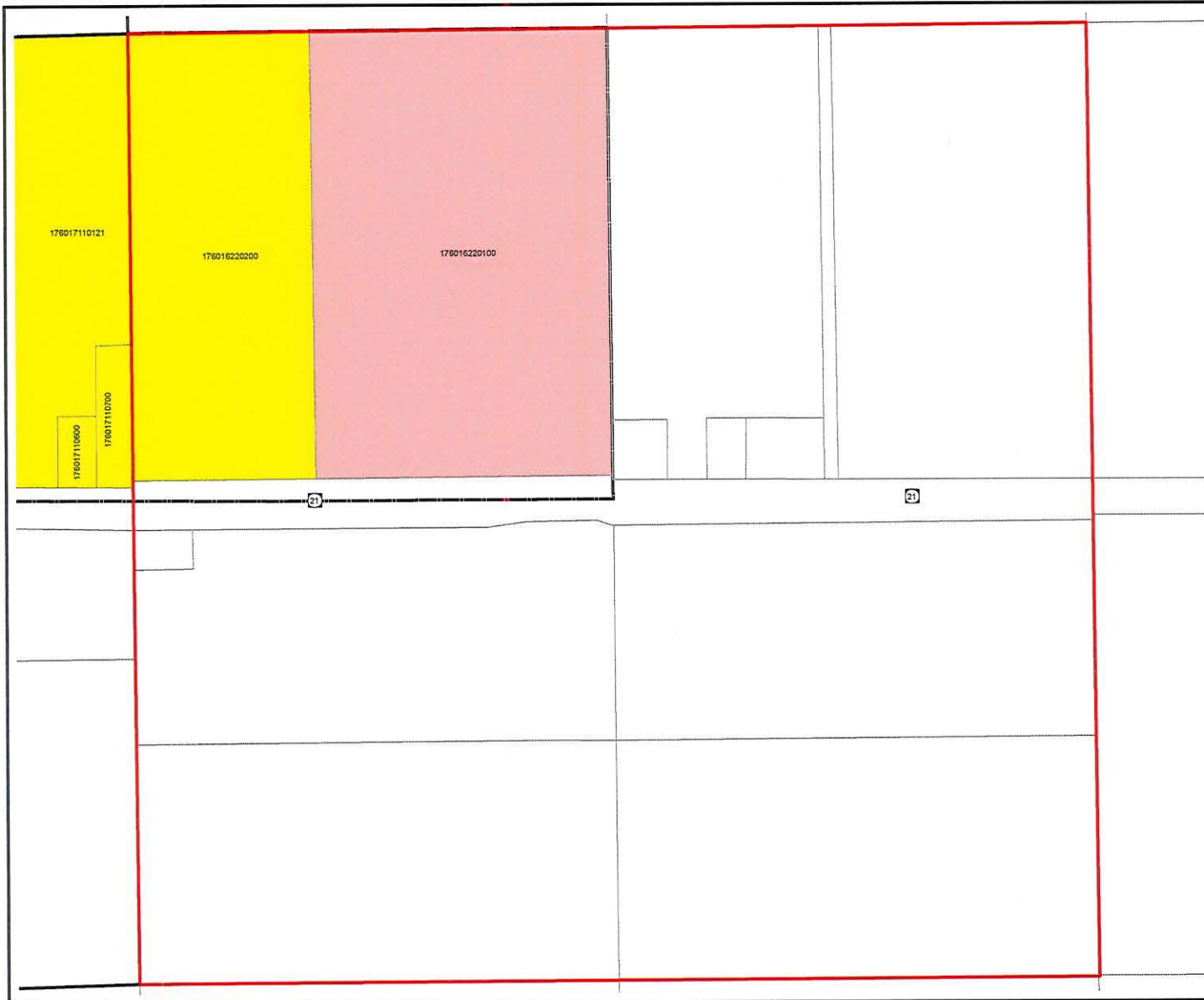

## VILLAGE OF REDGRANITE ZONING PAGE 15

-  AG HOLDING
-  RESIDENTIAL
-  MOBILE HOME PARK
-  COMMUNITY COMMERCIAL
-  HIGHWAY COMMERCIAL
-  INDUSTRIAL
-  TOWN OF WARREN
-  ROADS
-  WATER

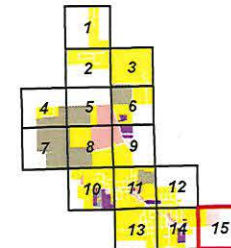

Source: Village of Redgranite Zoning, 2003  
Digital Base Data provided by Waushara County.

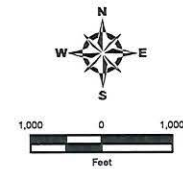

This data was created for use by the East Central Wisconsin Regional Planning Commission Geographic Information System. Any other use/application of this information is the responsibility of the user and such use/application is at their own risk. East Central Wisconsin Regional Planning Commission disclaims all liability regarding fitness of the information for any use other than for East Central Wisconsin Regional Planning Commission business.

Prepared By  
EAST CENTRAL WISCONSIN  
REGIONAL PLANNING COMMISSION-MAY 2013



## Village of Redgranite Zoning Matrix

	R-1	R-2	R-3	CC	HC	I	AG existing	AG New	MH
<b>Max. Height</b>	35 ft or 2 1/2 stories	35 ft or 2 1/2 stories	35 ft or 2 1/2 stories	35 ft or 2 1/2 stories	35 ft or 2 1/2 stories	35 ft or 2 1/2 stories	60 ft	60 ft	
<b>Min. Side yard</b>	6' min one side 10' on other	10 ft for 2 family	10 ft for multi-family	0' unless abut R then 10'	0' unless abut R then 10'	10ft, 25ft if abut R	25 ft	25 ft	20 ft space between units
<b>Min. Front setback</b>	25 ft	25 ft	25 ft	0 ft	40 ft	40 ft	50 ft	50 ft	20 ft
<b>Min. Rear Setback</b>	20 ft	20 ft	20 ft	0 ft	20 ft	20 ft	10 ft	50 ft	30 ft landscape barrier
<b>Min. Lot Size</b>	10,000 sq ft	12,000 sq ft	18,000 sq ft	0 ft	10,000 Sq Ft	20,000 Sq Ft	20,000 sq ft	5 Acres	5 Acres for park 5,000 sq ft per lot
<b>Min. Building Size</b>	720 sq ft first floor	576 sq ft first floor	576 sq ft first floor	N/A	N/A	N/A	N/A	N/A	14 x 60 Minimum < 5years old occupy < 33% of lot area
<b>Lot Frontage</b>	60 ft; 30' for cul de sac, 80' building	80 ft; 100' at building	100 ft; 100' at building	50 ft	60 ft; 80 ft at building setback	80 ft; 100 ft at building setback	120 ft	300 ft	
<b>Accessory Bldg Ht</b>	18'	18'	18'	35 '	35 '	35 '	60'	60'	
<b>Accessory Bldg Side Setback</b>	3'; 5' from alley	3'; 5' from alley	10'	10'	10'	10'	10'	10'	
<b>Accessory Bldg Rear Setback</b>	3'; 5' from alley	3'; 5' from alley	10'	10'	10'	10'	10'	10'	
<b>Max Accessory Bldg Size</b>	Total of all structures < 60%	Total of all structures < 60%	Total of all structures < 60%	N/A	N/A	N/A	N/A	N/A	Total of all structures < 66%
<b>Lot Building Coverage</b>	60%	60%	60%	N/A	N/A	N/A	N/A	N/A	66% of individual lots
<b>Min. Open Space Req'd</b>	40%	40%	40%	N/A	N/A	N/A	N/A	N/A	Min 250 Sq ft per lot
<b>Permitted Uses</b>	1.04 (1) A (b)	1.04 (1) A (b)	1.04 (1) A (b)	1.04 (2) A (b)	1.04 (3) A (b)	1.04 (4) A (b)	1.04 (5) (b)	1.04 (5) A	1.04 (6) A (b)
<b>Conditional Uses</b>	1.04 (1) A (C)	1.04 (1) A (C)	1.04 (1) A (C)	1.04 (2) A (C)	1.04 (3) A ©	1.04 (4) A (C)	1.04 (5) (d)	1.04 (5) (d)	